

**COF-09**  
**Approval Date: 14/03/16**

**Crossover Application**  
**Page 1 of 2**

## Application for Permit to Construct a New/Additional Vehicular Access

Application is hereby made to construct a new or additional vehicular access (*Rural A & B; Industrial or Residential*) to my property in accordance with the conditions of permit and the appropriate drawings.

<b>PLEASE NOTE: THE APPLICATION FEE MUST BE PAID BEFORE THE APPLICATION CAN BE PROCESSED</b>		
<b>Fees as per Current Fees and Charges Schedule</b>		
<u>2018-19 Fees</u>	Application Fee (incl Application, Processing & up to 1 inspection)	\$192.70
	Additional Inspections	\$102.50

--	--

*Owner of Property*

*Address of Crossover*

Lot/Plan:	(w) (h)	/ /
-----------	------------	-----

*Lot and Plan Number*

*Contact Phone Numbers*

*Date of Construction*

--	--	--

*Builder's Name*

*Builder's Address*

*Builder's Phone No.*

### Type of Crossover Required

- Rural A (Concrete Invert)   
  Rural B (Culvert)   
  Town Residential   
  Town Industrial \_\_\_\_\_  
*(Description)*

Please provide a sketch detailing the position of the proposed crossover in relation to the road, property boundary, existing footpath, power poles, fire hydrants, stop valves and any other utilities.

**IMPORTANT: The applicant must obtain all service locations and notify the Infrastructure & Utilities Department of the date and time of an inspection of the break in, boxing and reinforcing mesh (PRIOR TO THE CONCRETE BEING PLACED) so the inspection can be recorded as approved.**

### Conditions of Permit

1. The applicant indemnifies Council against cost incurred through damage to existing underground and/or above ground services.
2. Telstra have to be notified of the vehicular access to the property.
3. The applicant indemnifies Council against costs incurred through damage/injury to vehicles or public adjacent to the access construction.
4. Permit to construct is valid for 3 months after the Date of Application. After this period the permit is void and the applicant must re-apply.
5. The area is to be reinstated once works have been completed.
6. Excavation is to be barricaded on all sides to prohibit vehicular and/or pedestrian access.

I, the applicant, agree to adhere to the above Conditions of Permit.

\_\_\_\_\_/\_\_\_\_\_/\_\_\_\_\_  
*(Date)*

\_\_\_\_\_  
*Applicant's Signature*

**Office Use Only**

- |   |  |
|---|--|
| <input type="checkbox"/> Approval for Construction                          | <input type="checkbox"/> Receipt # _____                             |
| <input type="checkbox"/> Approval Withheld (letter of explanation attached) | <input type="checkbox"/> Approval with Special Conditions (attached) |
|   | <input type="checkbox"/> No crossover required                       |

\_\_\_\_\_/\_\_\_\_\_/\_\_\_\_\_  
*(Date)*

\_\_\_\_\_  
*Central Highlands Regional Council Officer's Signature*

**Sketch of Crossover**

Please provide a sketch of the crossover location in the box below. The sketch is to include locations of the existing:

- \* Water Meter (WM)
- \* Fire Hydrants (FH)
- \* Stop Valves (SV)
- \* Power Poles (PP)
- \* Trees (T)
- \* Footpath
- \* Road
- \* All property boundaries for the relevant block

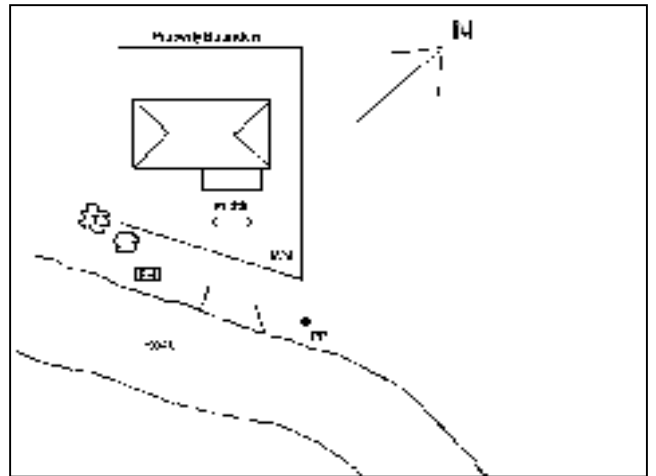

*Example Sketch including Central Highlands Regional Council Requirements*

**Inspection Report**

- |   |  |                                       |                                      |
|---|--|---------------------------------------|--------------------------------------|
| <input type="checkbox"/> Concrete             | <input type="checkbox"/> Gravel        | <input type="checkbox"/> Bitumen      | <input type="checkbox"/> Headwalls   |
| <input type="checkbox"/> Back of Kerb Removed | <input type="checkbox"/> Lay Back Kerb | <input type="checkbox"/> Pipe Culvert | <input type="checkbox"/> Box Culvert |

This Vehicular Access **is / is not** completed to Central Highlands Regional Council requirements.

\_\_\_\_\_/\_\_\_\_\_/\_\_\_\_\_  
(Date)

\_\_\_\_\_  
Central Highlands Regional Council Officer's Signature